

Vis HC à bout pointu DIN EN ISO 4027

Description de l'article/illustrations du produit



Description

Matière :

Acier ou Inox A2.

Finition :

Acier : classe de résistance 45 H, noir.

Inox : A2-70, poli.

Nota :

Pour M4x5, M5x5, M5x6, M6x6, M8x8, M10x10, l'angle de la pointe est à 120°

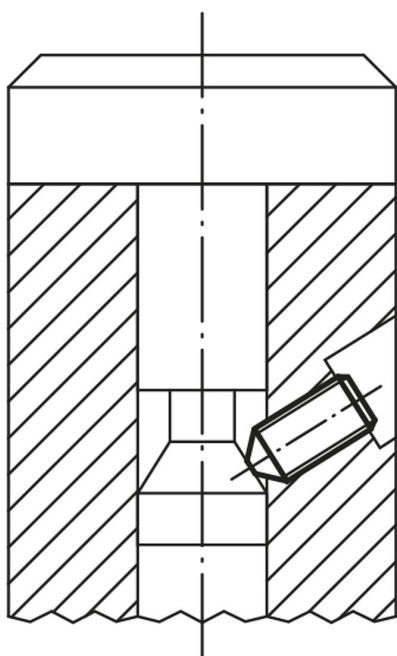

Dessins

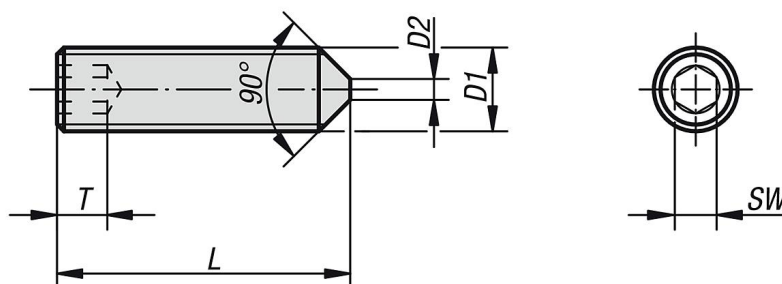

Aperçu des articles

Vis HC à bout pointu, DIN EN ISO 4027

Vis HC à bout pointu DIN EN ISO 4027

Aperçu des articles

Référence	Matière	D1	D2	L	T	SW
K0797.03X5	acier	M3	-	5	1,2	1,5
K0797.03X6	acier	M3	-	6	1,2	1,5
K0797.03X8	acier	M3	-	8	1,2	1,5
K0797.03X10	acier	M3	-	10	1,2	1,5
K0797.03X12	acier	M3	-	12	1,2	1,5
K0797.03X16	acier	M3	-	16	1,2	1,5
K0797.03X20	acier	M3	-	20	1,2	1,5
K0797.04X5	acier	M4	-	5	1,5	2
K0797.04X6	acier	M4	-	6	1,5	2
K0797.04X8	acier	M4	-	8	1,5	2
K0797.04X10	acier	M4	-	10	1,5	2
K0797.04X12	acier	M4	-	12	1,5	2
K0797.04X16	acier	M4	-	16	1,5	2
K0797.04X20	acier	M4	-	20	1,5	2
K0797.04X25	acier	M4	-	25	1,5	2
K0797.05X5	acier	M5	-	5	2	2,5
K0797.05X6	acier	M5	-	6	2	2,5
K0797.05X8	acier	M5	-	8	2	2,5
K0797.05X10	acier	M5	-	10	2	2,5
K0797.05X12	acier	M5	-	12	2	2,5
K0797.05X14	acier	M5	-	14	2	2,5
K0797.05X16	acier	M5	-	16	2	2,5
K0797.05X20	acier	M5	-	20	2	2,5
K0797.05X25	acier	M5	-	25	2	2,5
K0797.05X30	acier	M5	-	30	2	2,5
K0797.06X6	acier	M6	1,5	6	2	3
K0797.06X8	acier	M6	1,5	8	2	3
K0797.06X10	acier	M6	1,5	10	2	3
K0797.06X12	acier	M6	1,5	12	2	3
K0797.06X16	acier	M6	1,5	16	2	3
K0797.06X20	acier	M6	1,5	20	2	3
K0797.06X25	acier	M6	1,5	25	2	3
K0797.06X30	acier	M6	1,5	30	2	3
K0797.06X35	acier	M6	1,5	35	2	3
K0797.06X40	acier	M6	1,5	40	2	3
K0797.06X45	acier	M6	1,5	45	2	3
K0797.08X8	acier	M8	2	8	3	4
K0797.06X50	acier	M6	1,5	50	2	3
K0797.06X60	acier	M6	1,5	60	2	3
K0797.08X10	acier	M8	2	10	3	4
K0797.08X12	acier	M8	2	12	3	4
K0797.08X14	acier	M8	2	14	3	4
K0797.08X16	acier	M8	2	16	3	4
K0797.08X20	acier	M8	2	20	3	4
K0797.08X25	acier	M8	2	25	3	4
K0797.08X30	acier	M8	2	30	3	4
K0797.08X35	acier	M8	2	35	3	4
K0797.08X40	acier	M8	2	40	3	4
K0797.08X45	acier	M8	2	45	3	4
K0797.08X50	acier	M8	2	50	3	4
K0797.08X60	acier	M8	2	60	3	4
K0797.10X10	acier	M10	2,5	10	4	5
K0797.10X12	acier	M10	2,5	12	6	5
K0797.10X16	acier	M10	2,5	16	6	5
K0797.10X20	acier	M10	2,5	20	6	5
K0797.10X25	acier	M10	2,5	25	6	5
K0797.10X30	acier	M10	2,5	30	6	5
K0797.10X35	acier	M10	2,5	35	6	5
K0797.10X40	acier	M10	2,5	40	6	5
K0797.10X45	acier	M10	2,5	45	6	5
K0797.10X50	acier	M10	2,5	50	6	5
K0797.10X60	acier	M10	2,5	60	6	5

Vis HC à bout pointu DIN EN ISO 4027

Aperçu des articles

Référence	Matière	D1	D2	L	T	SW
K0797.10X70	acier	M10	2,5	70	6	5
K0797.10X80	acier	M10	2,5	80	6	5
K0797.103X5	acier inoxydable	M3	-	5	1,2	1,5
K0797.103X6	acier inoxydable	M3	-	6	1,2	1,5
K0797.103X8	acier inoxydable	M3	-	8	1,2	1,5
K0797.103X10	acier inoxydable	M3	-	10	1,2	1,5
K0797.103X12	acier inoxydable	M3	-	12	1,2	1,5
K0797.103X16	acier inoxydable	M3	-	16	1,2	1,5
K0797.103X20	acier inoxydable	M3	-	20	1,2	1,5
K0797.104X5	acier inoxydable	M4	-	5	1,5	2
K0797.104X6	acier inoxydable	M4	-	6	1,5	2
K0797.104X8	acier inoxydable	M4	-	8	1,5	2
K0797.104X10	acier inoxydable	M4	-	10	1,5	2
K0797.104X12	acier inoxydable	M4	-	12	1,5	2
K0797.104X16	acier inoxydable	M4	-	16	1,5	2
K0797.104X20	acier inoxydable	M4	-	20	1,5	2
K0797.104X25	acier inoxydable	M4	-	25	1,5	2
K0797.105X5	acier inoxydable	M5	-	5	2	2,5
K0797.105X6	acier inoxydable	M5	-	6	2	2,5
K0797.105X8	acier inoxydable	M5	-	8	2	2,5
K0797.105X10	acier inoxydable	M5	-	10	2	2,5
K0797.105X12	acier inoxydable	M5	-	12	2	2,5
K0797.105X14	acier inoxydable	M5	-	14	2	2,5
K0797.105X16	acier inoxydable	M5	-	16	2	2,5
K0797.105X20	acier inoxydable	M5	-	20	2	2,5
K0797.105X25	acier inoxydable	M5	-	25	2	2,5
K0797.105X30	acier inoxydable	M5	-	30	2	2,5
K0797.106X6	acier inoxydable	M6	1,5	6	2	3
K0797.106X8	acier inoxydable	M6	1,5	8	2	3
K0797.106X10	acier inoxydable	M6	1,5	10	2	3
K0797.106X12	acier inoxydable	M6	1,5	12	2	3
K0797.106X16	acier inoxydable	M6	1,5	16	2	3
K0797.106X20	acier inoxydable	M6	1,5	20	2	3
K0797.106X25	acier inoxydable	M6	1,5	25	2	3
K0797.106X30	acier inoxydable	M6	1,5	30	2	3
K0797.106X35	acier inoxydable	M6	1,5	35	2	3
K0797.106X40	acier inoxydable	M6	1,5	40	2	3
K0797.106X45	acier inoxydable	M6	1,5	45	2	3
K0797.106X50	acier inoxydable	M6	1,5	50	2	3
K0797.106X60	acier inoxydable	M6	1,5	60	2	3
K0797.108X8	acier inoxydable	M8	2	8	3	4
K0797.108X10	acier inoxydable	M8	2	10	3	4
K0797.108X12	acier inoxydable	M8	2	12	3	4
K0797.108X14	acier inoxydable	M8	2	14	3	4
K0797.108X16	acier inoxydable	M8	2	16	3	4
K0797.108X20	acier inoxydable	M8	2	20	3	4
K0797.108X25	acier inoxydable	M8	2	25	3	4
K0797.108X30	acier inoxydable	M8	2	30	3	4
K0797.108X35	acier inoxydable	M8	2	35	3	4
K0797.108X40	acier inoxydable	M8	2	40	3	4
K0797.108X45	acier inoxydable	M8	2	45	3	4
K0797.108X50	acier inoxydable	M8	2	50	3	4
K0797.108X60	acier inoxydable	M8	2	60	3	4
K0797.110X10	acier inoxydable	M10	2,5	10	4	5
K0797.110X12	acier inoxydable	M10	2,5	12	4	5
K0797.110X16	acier inoxydable	M10	2,5	16	4	5
K0797.110X20	acier inoxydable	M10	2,5	20	4	5
K0797.110X25	acier inoxydable	M10	2,5	25	4	5
K0797.110X30	acier inoxydable	M10	2,5	30	4	5
K0797.110X35	acier inoxydable	M10	2,5	35	4	5
K0797.110X40	acier inoxydable	M10	2,5	40	4	5
K0797.110X45	acier inoxydable	M10	2,5	45	4	5

Vis HC à bout pointu DIN EN ISO 4027**Aperçu des articles**

Référence	Matière	D1	D2	L	T	SW
K0797.110X50	acier inoxydable	M10	2,5	50	6	5
K0797.110X60	acier inoxydable	M10	2,5	60	6	5
K0797.110X70	acier inoxydable	M10	2,5	70	6	5
K0797.110X80	acier inoxydable	M10	2,5	80	6	5